

Wiring Diagram

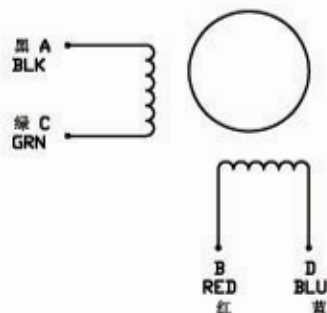

SPECIFICATIONS

1	Number of Phase	2
2	Step Angle	1.8° ±5%
3	Holding Torque	52 Kg. cm
4	Voltage	2.5 VDC
5	Current	5.0 A
6	Phase Resistance (20°C)	0.5 ±10%Ω
7	Phase Inductance (1KHz)	4.2 ±20% mH
8	Rotor Inertia	g • cm ²
9	Insulation Resistance	100MΩ 500VDC
10	Insulation Class	B (130°C)
11	Ambient Temperature	-20°C to 50°C
12	Ambient Humidity	15% to 95%
13	Motor Weight	Approx 3.0 kg
14		

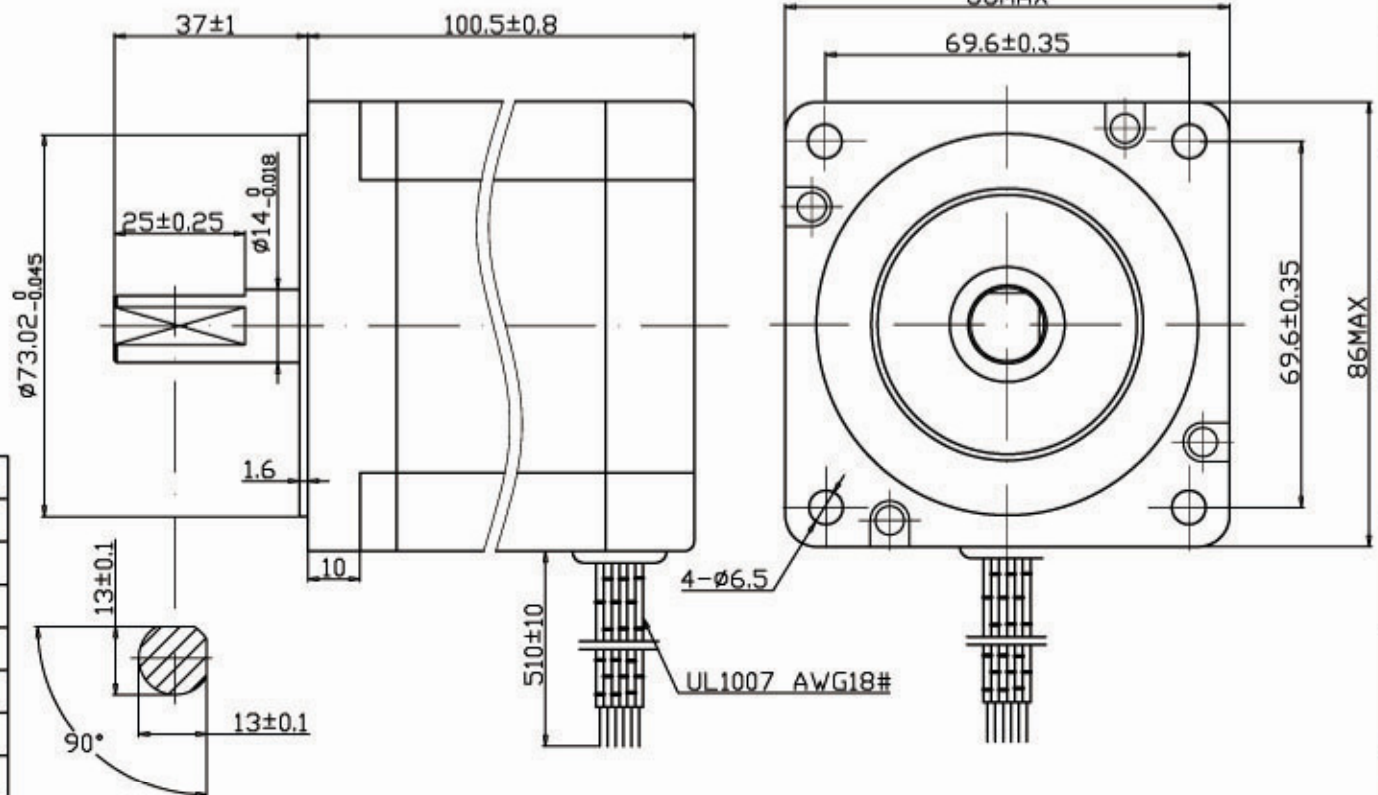

EXITING SEQUENCE (2 PHASE)

STEP	A	B	\bar{A}	\bar{B}	CCW
1	+	+	-	-	↑
2	-	+	+	-	
3	-	-	+	+	
4	+	-	-	+	↓

Unit:mm
 First angle method
 Tolerances for linear and angular dimensions without individual tolerance indications
 GB/T 1804-m eqv ISO 2768-1:m
 Geometrical tolerances for features without individual tolerance indications
 GB/T 1184-k eqv ISO 2768-2:k

DESIGN	
CHECK	
TECHNOLOGY	
STANDARD	
APPROVE	
NAMES	
SIGNATURE	
DATE	



TYPE: HYBRID STEPPING MOTOR SCALE XX Rev. 1.0 SHEET 1 OF 1

Model: 34HS86-5050A

V1.0	HTPS1603071	20160315
------	-------------	----------

REV.	REVISION RECORD	DATE
------	-----------------	------